

REVISIONS			
REV.	DESCRIPTION	DATE	BY
A	INITIAL RELEASE	2021-06-24	JHS

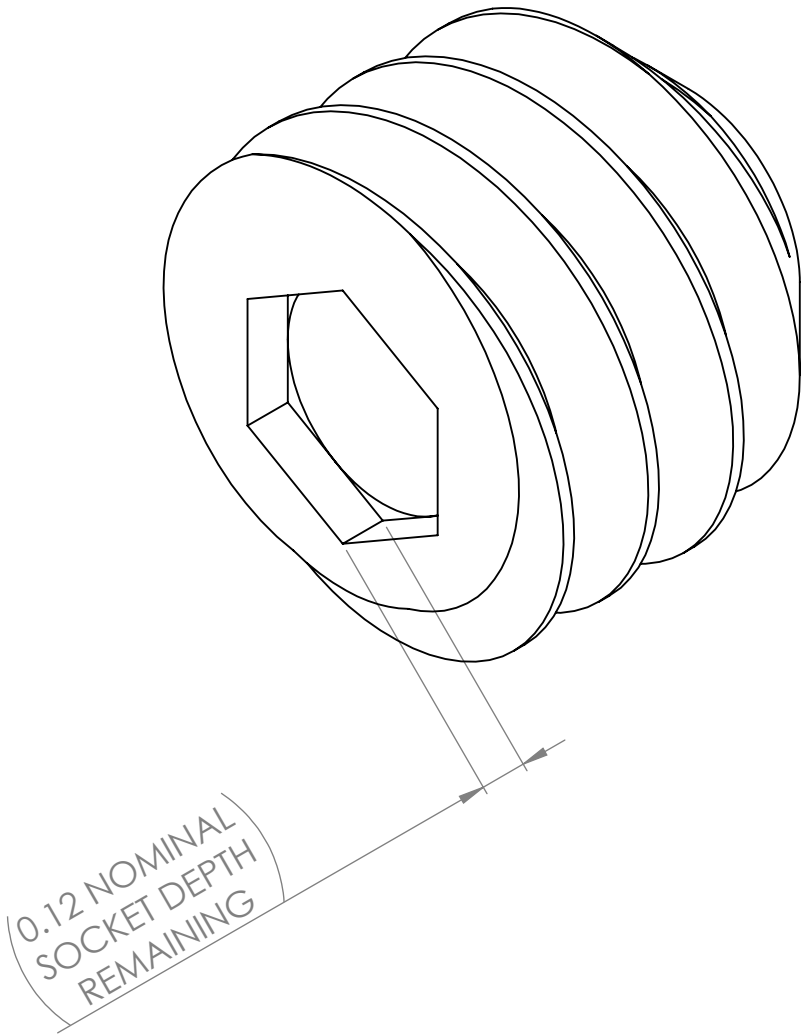
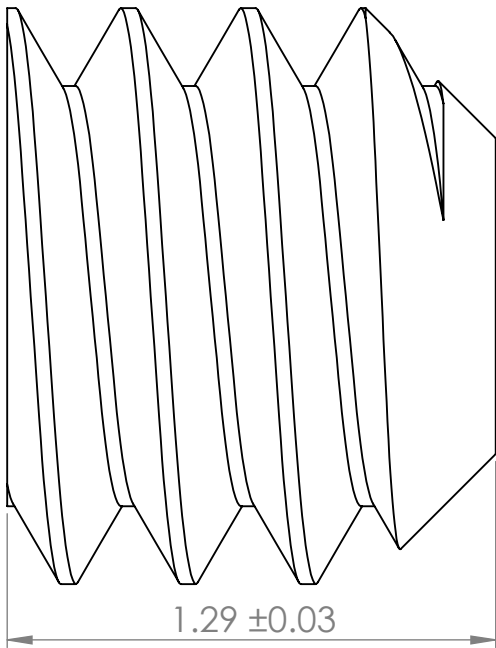
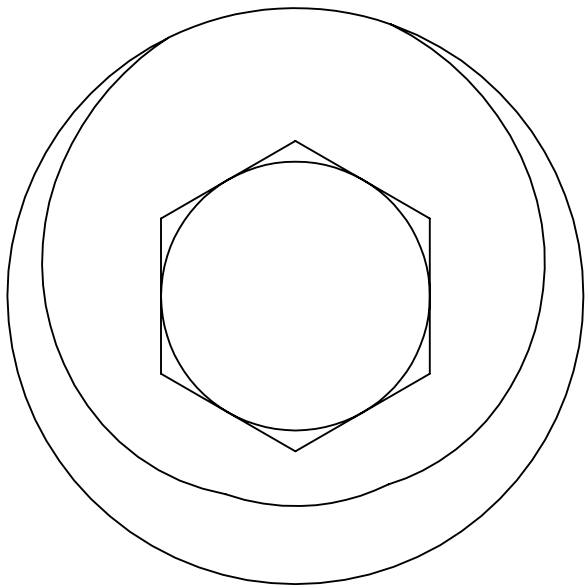

NOTES:

- STOCK 0-80 1/16" CUP POINT SET SCREW, REDUCED TO INDICATED LENGTH
- USE MCMASTER 9231 1A050 OR EQUIVALENT
- REMOVE MATERIAL FROM HEAD SIDE
- PLEASE CHECK SEVERAL SCREWS FROM EACH BATCH AND CONFIRM A SQUARE HEX DRIVER ACHIEVES SOME GRIP IN THE REMAINING AMOUNT OF SOCKET, SUFFICIENT TO ROTATE IN AND OUT OF A HOLE

UNLESS OTHERWISE SPECIFIED: DIMENSIONS IN MM TOLERANCES: ANGULAR ± 0.5° X ± 0.5 X.X ± 0.1 X.XX ± 0.05 X.XXX ± 0.010 GD&T PER: ASME Y14.5M-2009 MATERIAL 18-8 STAINLESS STEEL MACHINING FINISH: 3.2 micron EDGE BREAK: 0.1mm x 0.1mm PROJECTION: THIRD ANGLE DO NOT SCALE DRAWING		Ernest Orlando Lawrence Berkeley National Laboratory	
		PROJECT PHYSICS LDRD	
		TITLE: Shaft Coupler Set Screw II	
		SOLIDWORKS MODEL REVISION AT TIME OF RELEASE: 0004	
SIZE DWG. NO. REV		B TRL-0032 A	
SCALE: 50:1 WT: Kg		SHEET 1 OF 1	